

Recreation & Parks Advisory Committee Funding Application



Funding Applications must be submitted to the Parks & Facilities Department no less than 2 weeks prior to any RPAC meeting. Any incomplete applications will be returned and will not be placed on the RPAC agenda until all necessary documentation is submitted.

Recreational funding must be used to improve public safety, develop, expand, renovate or remodel parks, or to purchase land to build new parks.

I. APPLICATION INFORMATION

Date: November 1, 2021
 Local Government Name: Spring Lake Improvement District
 Project Manager: Joe DeCerbo
 Telephone: 863-655-1715 Email: jdecerbo@springlakefl.com

II. PROJECT SUMMARY

Project / Park Name: Pine Breeze Park Pickleball Courts
 Project address: 209 Spring Lake Blvd.
 Date approved by Governing Board: December 8, 2021 (PENDING)
 Who owns the property? Spring Lake Improvement District

		Percentage of Total Cost
Local funds available (<i>Requester's contribution</i>):		
Cash:	\$ <u>90,000.00</u>	<u>50%</u>
In-kind: (<i>Provide detailed data</i>)	\$ _____	____%
Other: (<i>Other agency funding, donations, etc.</i>)	\$ _____	____%
County funds request (<i>RPAC Share</i>):	\$ <u>90,000.00</u>	<u>50%</u>
Total cost of project:	\$ <u>180,000.00</u>	

All applicant/other funds will be used first. The balance, up to the approved RPAC recommendation, will be reimbursed by the County

Please provide a description of the proposed project which includes existing and future uses, existing and proposed physical improvements, and any existing buildings on site.

Pickleball has become a popular program in our District, and with the residential and apartment projects currently underway, there will be a number of new residents to participate in an expanded complex. Several groups and individuals have met with the District Manager and encouraged this initiative. This amenity would enhance our Pine Breeze Park Complex (see attached maps).

III. PROJECT COST ESTIMATE

Development/Remodel/Expansion Projects: Submit a conceptual site plan displaying the areas and facilities to be developed as proposed on this application. The site plan must CLEARLY DELINEATE facilities currently existing, facilities proposed for funding in this application and facilities planned for future development.

Acquisition Projects: If applying for an acquisition project, submit the proposed development for the project. Along with the breakdown of the facilities, submit a construction timeline for the required development of facilities. Also, submit conceptual site plan displaying the areas and facilities to be developed as proposed on this application.

NOTES:

- Applicant has 24 months for project completion from the date of the execution of the Interlocal Agreement by the Board of County Commissioners.
- With the exception of public safety needs, any previously approved major project must be completed prior to applying for another project to be funded.

<u>Budget Category</u>	<u>Total</u>
Administration Project Management	_____
Contracted Services	<u>2,500.00</u>
Permitting & Project Inspection Fees	<u>2,500.00</u>
Site Preparation	<u>4,000.00</u>
Demolition and Removal	<u>5,000.00</u>
Construction	<u>166,000.00</u>
Equipment (Rental, or in-kind use)	_____
Contingency Cost	_____
Other Cost: _____	_____
Total Project Cost: <u>180,000.00</u>	

Will local vendors be used: Yes No

Please list all vendors you received quotes and estimates from and attach with this application:

TBD

IV. OPERATION AND MAINTENANCE

Describe the on-going maintenance that will be provided by the municipality for the improvements in which funding is being requested.

- 1. The applicant has a full-time parks and recreation department that will manage the project site to provide programming and to ensure adequate operation and maintenance.
- 2. The applicant has a full-time staff, such as a public works, who will manage the project site to ensure adequate operation and maintenance.
- 3. The applicant will manage the project site with part-time staff or by contractual agreement to ensure adequate operation and maintenance.
- 4. An organized volunteer group, such as a civic group or youth sports association, will operate and maintain the site. Name of Organization:

If the expansion/remodel/renovation will REDUCE costs of maintenance/operation, and /or will eliminate a safety hazard, please provide a detailed explanation and back-up verification.

V. PROJECT INFORMATION

	Yes	No
Is this project part of the Master plan for a park and/or greenway system?	<input type="checkbox"/>	<input checked="" type="checkbox"/>
Is the project part of the three-year RPAC Planning Strategy? (2020-2023)	<input type="checkbox"/>	<input checked="" type="checkbox"/>
Is there a safety and/or health concern?	<input type="checkbox"/>	<input checked="" type="checkbox"/>
Is access hindered (i.e. damage roads, limited ADA compliance, etc.)	<input type="checkbox"/>	<input checked="" type="checkbox"/>
Is the project a service that is over populated due to size?	<input type="checkbox"/>	<input checked="" type="checkbox"/>
Will there be a charge or user fee: (attach fee schedule if applicable)	<input type="checkbox"/>	<input checked="" type="checkbox"/>
Public Involvement	<input type="checkbox"/>	<input checked="" type="checkbox"/>
	Public Meeting:	<input checked="" type="checkbox"/>
	Survey:	<input checked="" type="checkbox"/>
Petitioned: <input checked="" type="checkbox"/>		
How many Signatures? <u>116</u>		

Please list all amenities this park/location already provides.

Amenities	Yes	No	How Many?	Amenities	Yes	No	How Many?
Soft/Baseball Fields	<input type="checkbox"/>	<input checked="" type="checkbox"/>		Bicycling Trails	<input type="checkbox"/>	<input checked="" type="checkbox"/>	
Soccer Fields	<input type="checkbox"/>	<input checked="" type="checkbox"/>		Fitness Trails	<input type="checkbox"/>	<input checked="" type="checkbox"/>	
Tennis Courts	<input checked="" type="checkbox"/>	<input type="checkbox"/>	2	Hiking Trails	<input type="checkbox"/>	<input checked="" type="checkbox"/>	
Running Track(s)	<input type="checkbox"/>	<input checked="" type="checkbox"/>		Equestrian Trails	<input type="checkbox"/>	<input checked="" type="checkbox"/>	
Volleyball Courts	<input type="checkbox"/>	<input checked="" type="checkbox"/>		Nature Trails	<input type="checkbox"/>	<input checked="" type="checkbox"/>	
Basketball Courts	<input checked="" type="checkbox"/>	<input type="checkbox"/>	4	Swimming	<input type="checkbox"/>	<input checked="" type="checkbox"/>	
Pickleball Courts	<input type="checkbox"/>	<input checked="" type="checkbox"/>		Camping	<input type="checkbox"/>	<input checked="" type="checkbox"/>	
Bocce Ball Courts	<input type="checkbox"/>	<input checked="" type="checkbox"/>		Picnic Tables	<input checked="" type="checkbox"/>	<input type="checkbox"/>	12
Horseshoe Pits	<input type="checkbox"/>	<input checked="" type="checkbox"/>		Pavilions	<input checked="" type="checkbox"/>	<input type="checkbox"/>	1
Drinking Fountains	<input checked="" type="checkbox"/>	<input type="checkbox"/>	3	Grills	<input checked="" type="checkbox"/>	<input type="checkbox"/>	3
Other: _____				Playground	<input checked="" type="checkbox"/>	<input type="checkbox"/>	1

VI. CONCLUSION

Please attach quotes, estimates, photos, conceptual site plans, surveys, and petitions with this application.

Email application to the Parks & Facilities Management office at Facility@highlandsfl.gov or mail/deliver to 636 Fernleaf Ave in Sebring.

PINE BREEZE PARK EXPANSION

- 1 Site for pickleball courts
- 2 Shelter
- 3 Bathrooms
- 4 Community Center
- 5 Fishing areas
- 6 Basketball Courts
- 7 Children's Playground
- 8 District Offices



Highlands County Property Appraiser



C-15-35-30-020-P010-0010

[//www.hcpao.org/Search/Parcel/303515020P0100010C](http://www.hcpao.org/Search/Parcel/303515020P0100010C)

209 SPRING LAKE BLVD
SEBRING, FL 33876-

Owners
SPRING LAKE IMPROVEMENT DIST

Legal Description
SPRING LAKE VILLAGE II
PB 9 PG 43
W 500 FT OF PARCEL 1 LESS
S 275 FT
5.88 ACRES M/L

Mailing Address
115 SPRING LAKE BLVD
SEBRING, FL 33870-6143

DOR Code: 89 - MUNICIPAL
Neighborhood Code: 1226 - SPRING LAKE VILLAGE VI N
OF 98

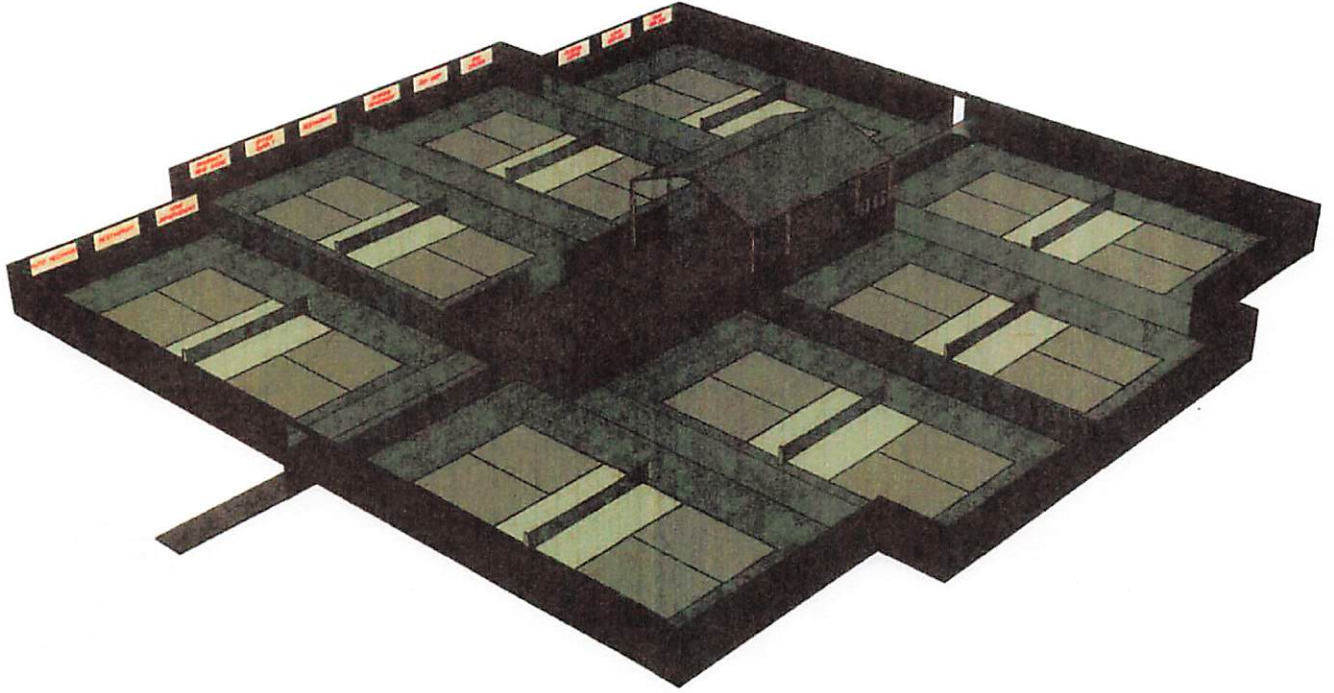

PERSPECTIVE VIEW 1

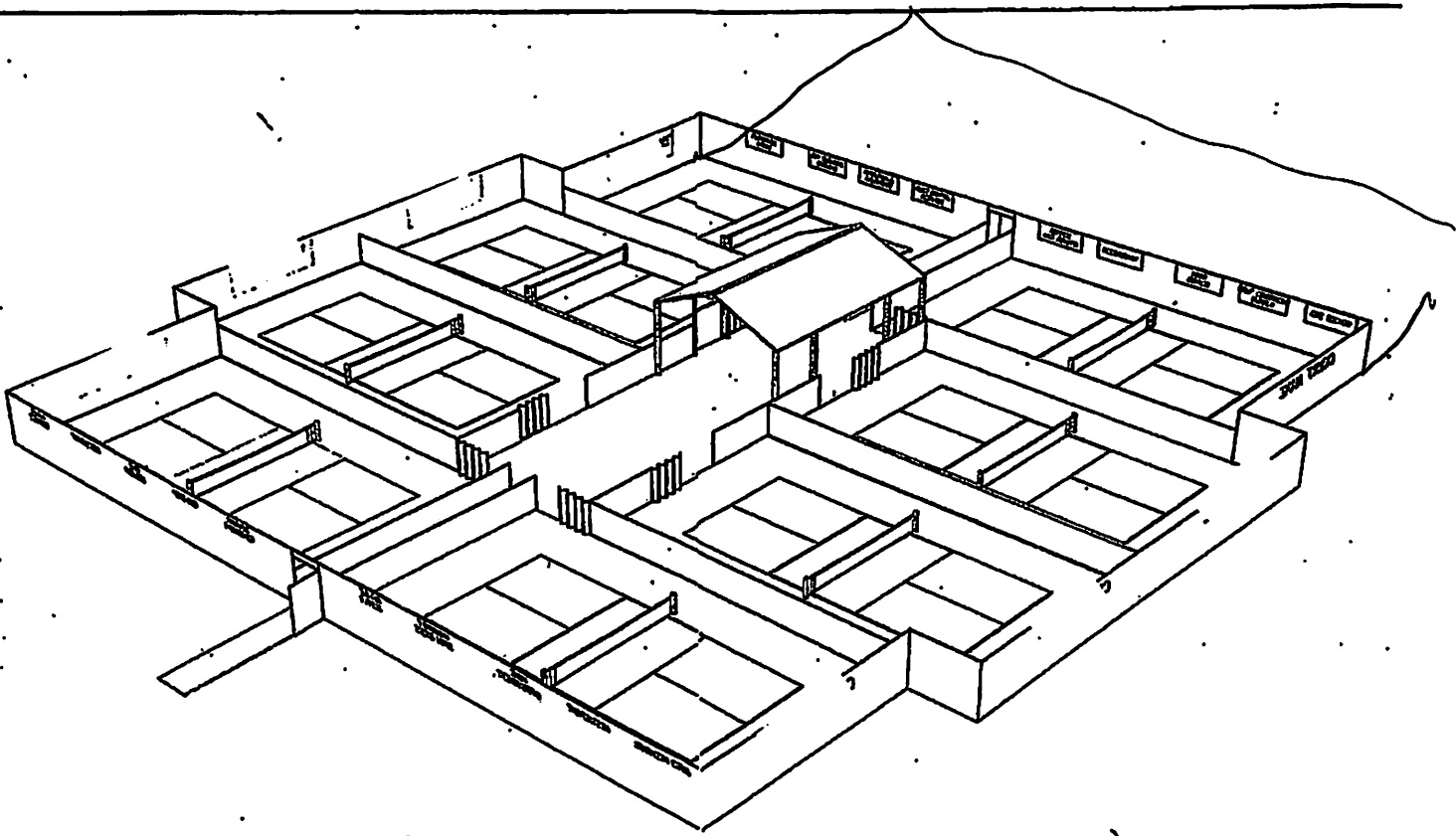

PERSPECTIVE VIEW 1